

## **AIPL THE PEACEFUL HOMES**

*Advance India Projects Limited (AIPL)* is a leading property development company, offering a wide range of residential, commercial and retail properties across Delhi NCR and Punjab. For almost the past three decades, AIPL has grown dramatically and continuously in their ability to offer new heights of quality developments via innovation and excellence. Headquartered in New Delhi with 6 regional offices in 3 states across India, AIPL has successfully delivered more than 50 landmark projects over 25 years. AIPL has pioneered themselves as a major player by fulfilling their commitments and delivering their projects on time.

### ***LOCATION***

Sector 70A,  
Gurugram.

### ***AREA***

11.5 Acres  
land parcel\*

### ***SIZE***

1565 sqft. onwards

*At The Peaceful Homes, the only thing you won't find is the reason to worry. Choices of 2/3/4 Bedroom Multi-storey premium residences spread over sprawling greens with panoramic views of the Aravali range.*

*Has convenient Shopping centre, exclusive Club, 24X7 power back-up, well connected to NH-8 & Sohna road with proximity to SPR (Southern Periphery Road), 24x7 water supply, efficient elevators, fire protection & detection system, 24 hrs. Security with access control & CCTV surveillance. Offers Swimming pool, Tennis court, Badminton court, Basketball practice court, Football practice court, Kids' play area, Skating zone, Library/Reading room, Gym, Open air LED screen, Barbeque area, Spa sauna steam, Billiards room, mini Home Theatre, Business Centre, Water feature, Lawns, Hopscotch, Jogging track, Pet Garden, Grocery store, Florist, ATM, Laundromat, Mobile shop, Courier collection shop, Path lab, Dry cleaning, Bakery, Fruits and veggies, Saloon, Stationery, Tailor, Departmental store et cetera. Facility for charging electric vehicles, Waiting area, Dual energy billing system, Auto car wash, access for Differently-abled, Intercom, AC entrance lobby, Garbage disposal system, Water drainage & recharge, Rain water Harvesting, solid waste management systems.*

*Semi-furnished with AC and Modular Kitchen.*

*In short, there is no peace without pleasure, and AIPL's TPH, offers it all!*

# Gurugram गुरुग्राम

Sign in

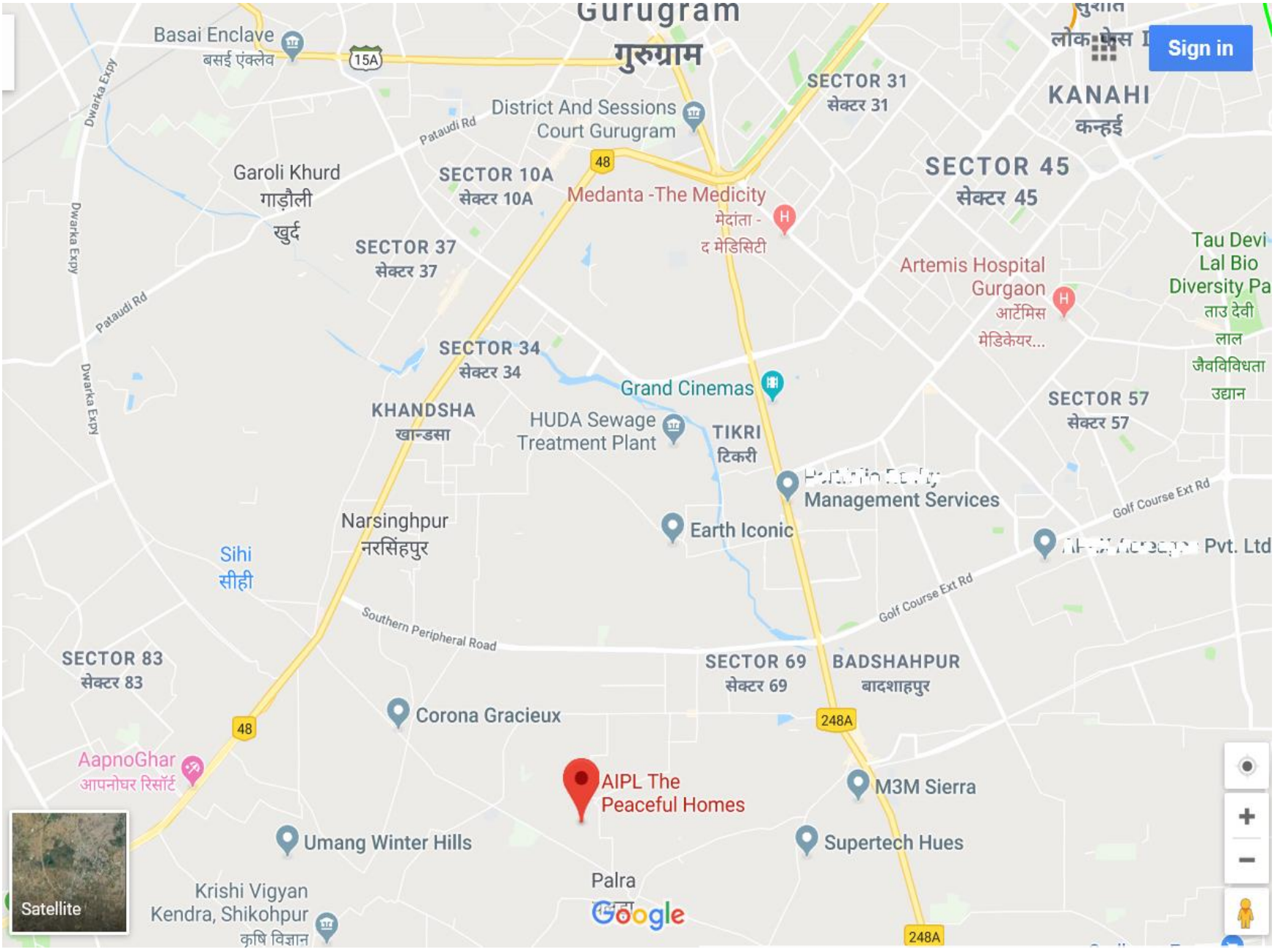

Basai Enclave  
बसई एंक्लेव

Garoli Khurd  
गाड़ौली  
खुर्द

SECTOR 10A  
सेक्टर 10A

SECTOR 37  
सेक्टर 37

SECTOR 34  
सेक्टर 34

KHANDSHA  
खान्डसा

Narsinghpur  
नरसिंहपुर

Sihi  
सीही

SECTOR 83  
सेक्टर 83

AapnoGhar  
आपनोघर रिसॉर्ट

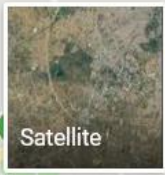

Krishi Vigyan  
Kendra, Shikohpur  
कृषि विज्ञान

Umang Winter Hills

Corona Gracieux

AIPL The  
Peaceful Homes

Palra  
गुल्लाना  
Google

SECTOR 69  
सेक्टर 69

BADSHAHPUR  
बादशाहपुर

M3M Sierra

Supertech Hues

District And Sessions  
Court Gurugram

Medanta -The Medicity  
मेदांता -  
द मेडिसिटी

SECTOR 45  
सेक्टर 45

Artemis Hospital  
Gurgaon  
आर्टेमिस  
मेडिकेयर...

Grand Cinemas

TIKRI  
टिकरी

Partnership  
Management Services

Earth Iconic

SECTOR 57  
सेक्टर 57

NIPAA Microcap Pvt. Ltd

Tau Devi  
Lal Bio  
Diversity Pa  
ताउ देवी  
लाल  
जैवविविधता  
उद्यान





**THE PEACEFUL  
HOMES**

PREMIUM RESIDENCES AT GURGAON



MAY YOU FOREVER

*glide on the*

WINGS OF JOY



AIPL Homes is an endeavor by AIPL to develop  
aesthetic residential spaces of premium quality

## THE *peaceful* LOCATION

- Close proximity to Southern Periphery Road (Sohna Road)
- Immediate access to NH 8 and Golf Course Road.
- International schools like Indus World, GD Goenka, Heritage and Amity in vicinity.
- Medanta, Fortis, Artemis and Max hospitals in vicinity.
- The best MNCs, Colleges and Universities of Gurgaon just a short drive away.
- Close to three golf courses Classic Golf Resort, Golden Greens & DLF Golf and Country Club.



### LEGEND

- AIPL PROJECT
- HOTEL
- METRO
- HOSPITAL
- SCHOOL
- PROFESSIONAL INSTITUTION
- EXISTING METRO LINE
- PROPOSED METRO LINE
- RAPID METRO LINE
- PROPOSED RAPID METRO LINE



# Site Map

## LEGEND

1. Adult Pool
2. Kid's Pool
3. Lounge Pool
4. Pool Deck
5. Tennis Court
6. Badminton Court
7. Practice Basketball Court
8. Practice Football Ground
9. Drop Off Plaza
10. Kid's Play Area
11. Children's Play
12. Skating Zone
13. Water Feature
14. Water Body
15. Mound
16. Ramp
17. Lawn
18. Hopscotch
19. Parking Area
20. Jogging Track



Not to scale

## IT'S ALL BEEN TAKEN *care* OF

In AIPL's definition, The Peaceful Homes is not just about the serene and peaceful location of the said project but also a peaceful experience through the journey starting from the booking of your apartment through completion and handover.

Even after handover, AIPL endeavours to provide complete support to eliminate the hassles of moving into a new community for a better quality of life and living experience thereby ensuring a complete stress free and peaceful lifestyle in sync with the philosophy and core values of the company.



Artistic Impression of Facade



Artistic Impression of Entrance



Actual Image of Tower Drop Off



Actual Image of Tower Drop Off



Actual Image of Entrance Lobby



Actual Image of Entrance Lobby





Actual Image of Entrance Lobby

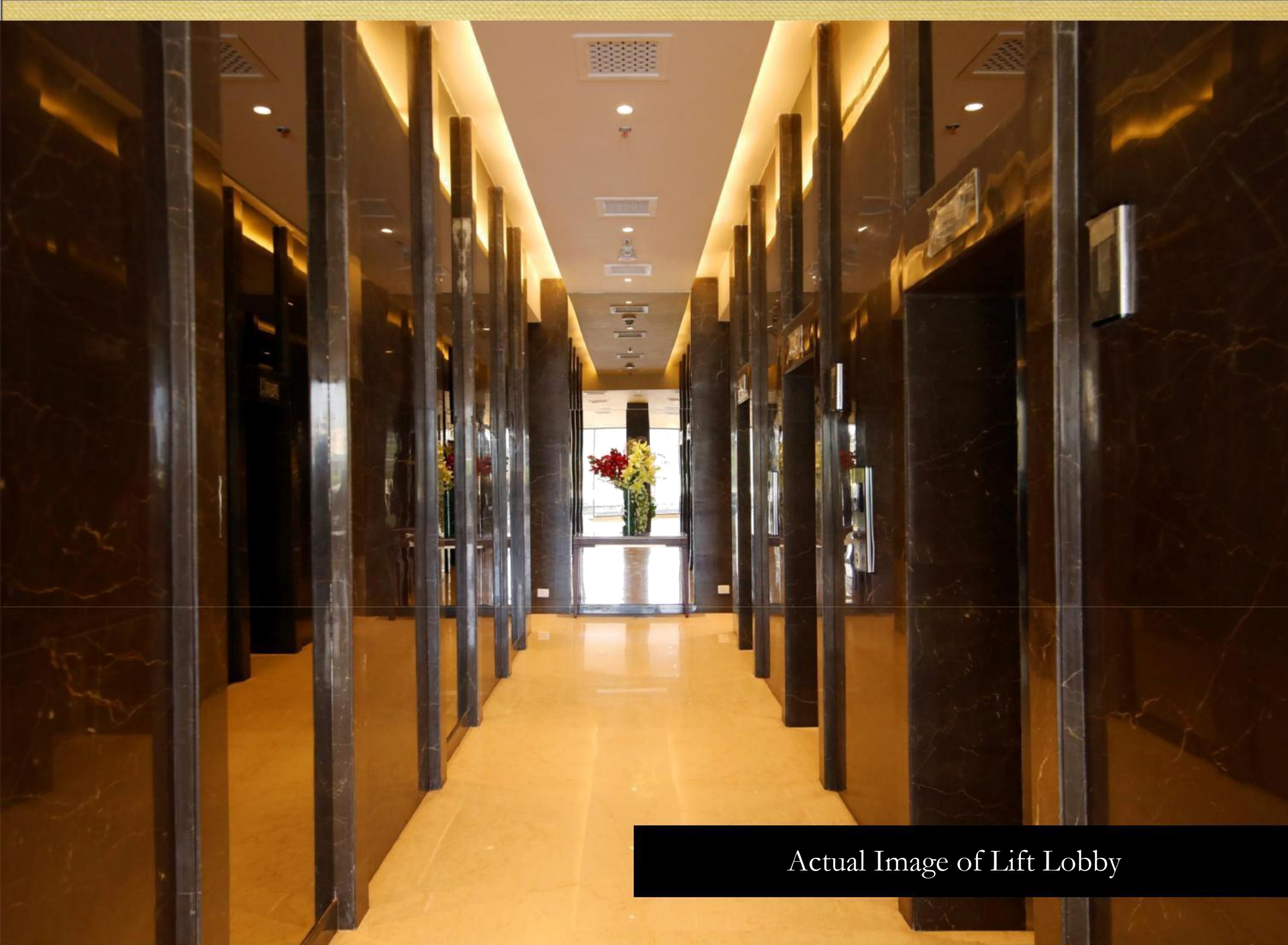

Actual Image of Lift Lobby



Stilt Area - Kids Play Area, Snooker Table, Bar, BBQ



Stilt Area - BBQ Corner, Bar Counter, Seating



AIPL  
Boulevard

24 SEVEN

24 SEVEN

CHILL ICE

THE DAY

NEXT STORE

NIGHT FOOD

HERBAL-I

TEA U TEA

WEEK-OUT

UP DATE

WORKSPACE

MAGAZ

GAM

Artistic Impression of Shopping Plaza

## THE *peaceful* RESIDENCE

At The Peaceful Homes, the only thing that you will not find is a reason to worry. This wonderland has been brought together by employing the most progressive technologies in construction and topped off with an aesthetic sense that is as impeccable as it is rare.

- Choices of 2/3/4 Bedroom Premium Residences
- Spread over sprawling greens
- Multi-Storey Premium Homes
- Panoramic views of the Aravalli range

- **Convenience Centre**
- **Exclusive club with modern facilities**
- **24x7 DG Power back-up**
- **24x7 treated water supply**
- **Efficient passenger elevators**
- **Fire fighting system as per NBC norms**
- **24 hrs. security with access control at entrance & CCTV surveillance**

## THE *peaceful* PARADISE

Experience the perfect union of nature and architecture at The Peaceful Homes. As you meander through the evergreen trees, you will discover a beautiful ode to nature round every bend. Spread over endless sprawling greens, with only a limited number of towers for residential spaces, The Peaceful Homes is built with a focusing on the health of its residents. Embark upon a journey of discovery. Of yourself. Of life.



NEVER BEFORE OPEN AREAS AND GREENS



- Exquisite water bodies
- Flowering plants
- Evergreen trees
- Waste segregation
- Water management system with maximum recycling of used water
- **CLIMATE RESPONSIVE DESIGN:** Addressing cross aeration and natural daylight requirements, right from the apartment level to the shaded and well-ventilated pedestrians and play regions.
- **ECOLOGICAL LANDSCAPE:** Harvesting, storing, distributing and reusing rain water, storm water and grey water deployments are to maximize both human being and ecological proceeds.



Artistic Impression of Main Driveway



Artistic Impression of Pool Area



Artistic Impression of Kid's Play Area



Artistic Impression of Landscaped Greens



Artistic Impression of Landscaped Greens

# THE *peaceful* EXPERIENCE

What's peace without pleasure? At The Peaceful Homes we have ensured every little detail to fill your days with magical moments and your evenings with unforgettable memories.

- Air-Conditioned Apartments
- Premium Brand Modular Kitchen with Hob & Chimney



**Air**  
**Conditioned**  
APARTMENTS



**MODULAR**  
**KITCHEN**

- **BEST Fire Fighting as per International Standards**
- **External Glazing**
- **Jogging track**
- **Pet garden**
- **Meditation garden**
- **Badminton/Basketball/Football practice courts**
- **Driver waiting area**
- **Convenient location of amenities like nursery, primary schools, recreational club, retail areas**



- Provision of Grocery store, Florist, ATM, Laundromat, Mobile shop, Courier collection shop, Facility shop, Dry cleaning/Ironing, First aid room/Pathology lab/Chemist, Bakery, Fruits & Vegetables, Saloon, Stationery, Tailor, Shoe shop/cobbler, Small departmental store Facility for charging electric vehicles- both two-wheelers & four-wheelers
- Dual energy prepaid billing system
- Access for disabled
- Services Convenience for support staff
- Auto car wash
- Separate service elevators for domestic help

- Provision for intercom facility
- Ground Floor + basements : Air-conditioned entrance lobby
- Eco friendly design concepts
- Garbage disposal system-Chutes
- Storm water drainage & recharge
- 100% groundwater recharge through rain water harvesting structure
- Re-use of treated water from central STP for flushing and horticulture
- Solid waste management through efficient collection and transportation systems



Actual Image of Living Room in Sample Apartment



Actual Image of Washroom in Sample Apartment



Actual Image of Bedroom in Sample Apartment



Actual Image of Kitchen in Sample Apartment

## THE *peaceful* DESIGN

Designed to maximize efficiency and space, each residential unit at The Peaceful Homes is a study in design. Each premium residence has been crafted with the delicate balance of planning and practicality to create spaces as endless as your dreams.



**4 Bedroom + Utility Room**  
**2925 Sq. Ft. - Super Area**

1 sq. meter = 10.764 sq. ft

Disclaimer : All pictures, plans, layouts, renderings, areas, dimensions and specifications contained in this collateral are indicative only and may change for the improvements in project or as approved by the competent authorities.





## 3 Bedroom + Utility Room : Type 3

### 2475 Sq. Ft. - Super Area

1 sq. meter = 10.764 sq. ft

Disclaimer : All pictures, plans, layouts, renderings, areas, dimensions and specifications contained in this collateral are indicative only and may change for the improvements in project or as approved by the competent authorities.



**3 Bedroom + Utility Room : Type 2**  
**2350 Sq. Ft. - Super Area**

1 sq. meter = 10.764 sq. ft

Disclaimer : All pictures, plans, layouts, renderings, areas, dimensions and specifications contained in this collateral are indicative only and may change for the improvements in project or as approved by the competent authorities.



## 3 Bedroom : Type 1 2150 Sq. Ft. - Super Area

1 sq. meter = 10.764 sq. ft

Disclaimer : All pictures, plans, layouts, renderings, areas, dimensions and specifications contained in this collateral are indicative only and may change for the improvements in project or as approved by the competent authorities.

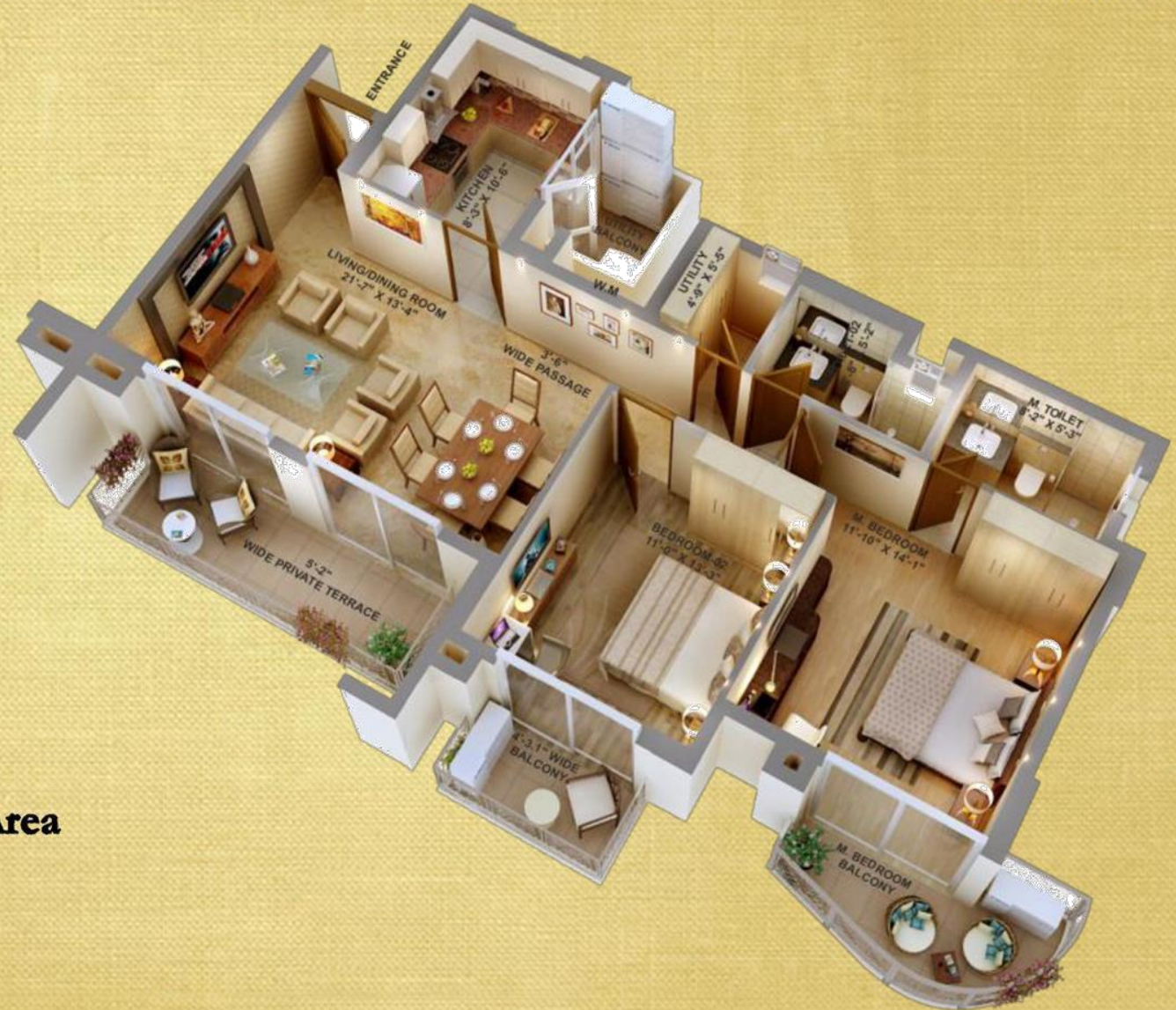

**2 Bedroom**  
**1565 Sq. Ft. - Super Area**

1 sq. meter = 10.764 sq. ft

Disclaimer : All pictures, plans, layouts, renderings, areas, dimensions and specifications contained in this collateral are indicative only and may change for the improvements in project or as approved by the competent authorities.

# SPECIFICATIONS

<i>Location</i>	Living Room	Master Bed Room	Other Bed Rooms	Kitchen
<i>Walls</i>	Acrylic emulsion paint	Acrylic emulsion paint	Acrylic emulsion paint	Ceramic Tiles upto 2 feet above the counter and rest Acrylic emulsion paint
<i>Floor</i>	Imported marble / Engineered Stone	Laminated Wooden flooring	Laminated Wooden flooring	Anti-Skid Ceramic Tiles
<i>Ceiling</i>	OBD	OBD	OBD	OBD
<i>Doors</i>	Veneered with polish	Internal door: Skin moulded shutters	Internal door: Skin moulded shutters	Internal door: Skin moulded shutters
	External door: UPVC / Aluminium	External door: UPVC / Aluminium	External door: UPVC / Aluminium	External door: UPVC / Aluminium
<i>Window Glazing</i>	UPVC / Aluminium	UPVC / Aluminium	UPVC / Aluminium	UPVC / Aluminium
<i>Others</i>	Split AC	Split AC	Split AC	Modular Kitchen with Hob & Chimney, Granite counter top, double bowl stainless steel sink & CP fittings

Location	Balconies & Terraces	Toilets	Powder Room*	Utility Room	Utility Toilets
<i>Walls</i>	Weather proof paint	Ceramic Tiles upto Door height, rest Acrylic Emulsion	Ceramic Tiles upto Door height rest Acrylic Emulsion	OBD	Ceramic Tiles upto Door Height, rest OBD
<i>Floor</i>	Anti-Skid Ceramic Tiles	Anti-Skid Ceramic Tiles	Anti-Skid Ceramic Tiles	Anti-Skid Ceramic Tiles	Anti-Skid Ceramic Tiles
<i>Ceiling</i>	Weather proof paint	OBD	OBD	OBD	OBD
<i>Doors</i>	UPVC / Aluminium	Internal door: Skin moulded shutters	Internal door: Skin moulded shutters	Flush Door with Enamel Paint	Flush Door with Enamel Paint
				External door: UPVC / Aluminium	
<i>Window Glazing</i>	UPVC / Aluminium	UPVC / Aluminium	UPVC / Aluminium	UPVC / Aluminium	UPVC / Aluminium
<i>Others</i>	MS / Glass Railings	Quality Chinaware, CP fittings, Natural Stone counter	Quality Chinaware, CP fittings, Natural Stone counter	-	Conventional CP fittings, White Chinaware

# THE *peaceful* CLUB

Bliss is the centerpiece of life at The Peaceful Homes. And what better way to find it than in the midst of your family and friends. Welcome to Tantra – an ultramodern club brimming with one thoughtful facility after another. Be it entertainment, sports, recreation, lifestyle, or any other leisure, you will find it all here.





Artistic Impression of Club Residences



## SURRENDER TO THE *magic* OF TANTRA - THE CLUB

- Multi purpose hall
- Library / Reading room
- Yoga center
- Gymnasium
- Spa facilities, sauna and steam
- Business Centre
- Concierge Desk
- Swimming pool



- Mini home theatre
- Billiards room and Table Tennis facility
- Wifi in landscaped areas with laptop charging sockets
- Piped music in Landscaped areas
- Guest Rooms
- Barbeque Area
- Lounge Area
- Open air LED screen

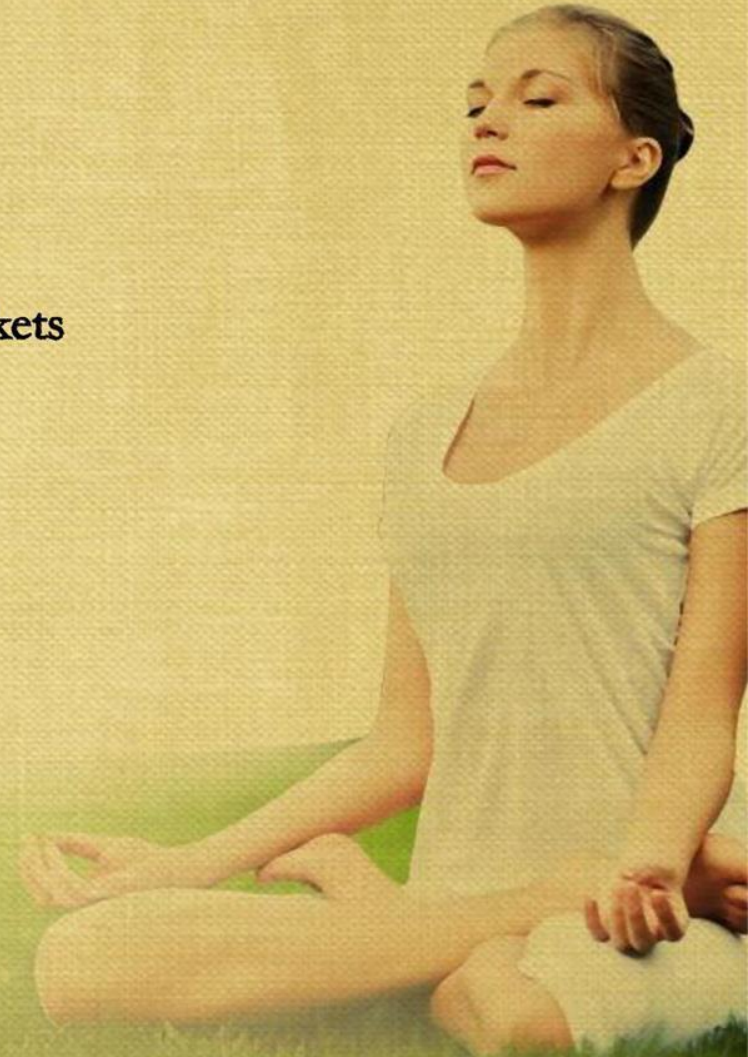

**Preferred Channel Partner**



**For more information:-**

**CALL : +91-9811107732,**

**: +91-7042772403.**



Disclaimer : All images, designs etc. are artistic impression only. All images, designs, perspectives, features, plans, areas, figures, dimensions, category, services, facilities, specifications, infrastructure etc. are illustrative, tentative, indicative only and the company reserves all the rights to withdraw, vary, modify, amend all/any of these without any notice or on account of govt. norms/directions. 1 Hectare = 2.471 Acres, 1 Acre = 4840 square yards or 4046.873 square meters: 1 square yard = 0.8361 square meters: 1 square meter = 10.764 square foot. The Peaceful Homes -Licence no. 16 of 2009 & Licence no. 73 of 2003, Memo no. ZP-545/AD(RA)/2017/1238. The project in Gurgaon is duly approved/Licensed by the office of Director General, Town & Country Planning. All the approvals can be checked in the office of the Developer. The Developer reserves the right to get the approved building plans revised at any stage till completion of the project as per prevailing government norms.

©2018. Deepak Estate is a registered firm/mark under Trade Marks Act. Project information may change/vary without its relevant update on our website. Please go through all the latest/relevant T&Cs/documents and be fully satisfied prior to finalising any deal. The project details are purely for the purpose of providing information and are not a legal offering. Deepak Estate takes no guarantee, nor assumes any legal liability or responsibility for the accuracy, correctness or completeness of any information available on our website. Our firm shall not be held responsible. Some images/pictures used on this website might be copyright protected by someone else. In case you have any objection in this regard, please contact/intimate us so that we can delete the objectionable pictures from the website within a reasonable time. We don't wish to take any credit or use them for any commercial/monetary gains. Maps may not be to scale or cent percent accurate. Any access/use of this website, is and will be, at the risk of the user. We have no intentions of misusing any details entered by you in the enquiry form. Images may not reflect the actual design.